

Town of Gibraltar - Fish Creek Beach

CONSTRUCTION PLANS - 90% COMPLETE

JOB NUMBER
23258

LOCATED IN:
GOVERNMENT LOT 4 OF SECTION 29,
TOWNSHIP 31 NORTH, RANGE 27 EAST
VILLAGE OF FISH CREEK, DOOR COUNTY, WISCONSIN

PROPERTY ADDRESS:
4108 / 4112 MAIN ST.
FISH CREEK, WI 54212

PARCEL ID:
014-15-0302B, 0303B, AND 0105

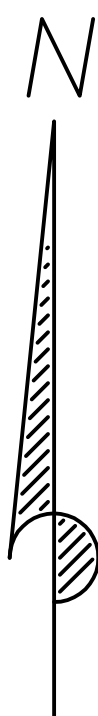
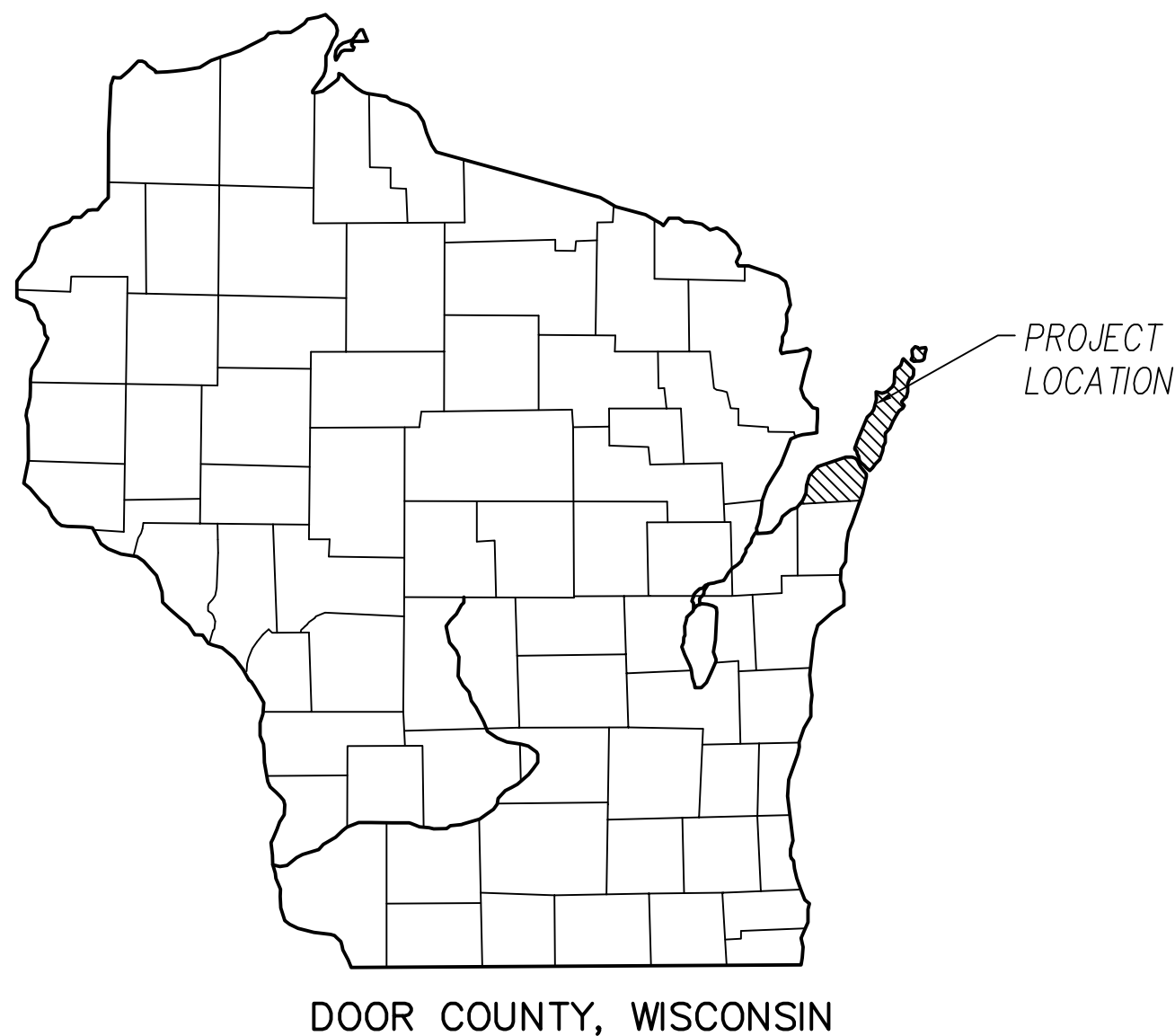

INDEX OF SHEETS	
SHEET NO.	DESCRIPTION
C000	COVER
C100	DEMO & EROSION CONTROL PLAN
C101	GRADING PLAN
C102	IRRIGATION PLAN
C103	LANDSCAPE PLAN
C200	CONSTRUCTION DETAILS
C201	CONSTRUCTION DETAILS
C202	CONSTRUCTION DETAILS

REUSE OF DOCUMENTS
THIS DOCUMENT HAS BEEN DEVELOPED FOR
A SPECIFIC APPLICATION AND NOT FOR
GENERAL USE. THEREFORE IT SHOULD NOT BE
REUSED IN ANY OTHER PROJECT WITHOUT THE
APPROVAL OF BAUDHUIN INCORPORATED. UNAPPROVED USE
IS THE SOLE RESPONSIBILITY OF THE
UNAUTHORIZED USER.

C000

1

BAUDHUIN

SURVEYING &
ENGINEERING

Town of Gibraltar - Fish Creek Beach

4108/4112 Main St.
Fish Creek, WI 54212

REVISION DATE:

DESCRIPTION

DESIGNED BY:
R.J.H.

DATE:
06-30-20

JOB NUMBER:
23258

312 N. 5TH AVE.
P.O. BOX 105
STURGEON BAY, WI.
54235

PHONE: 920-743-8211

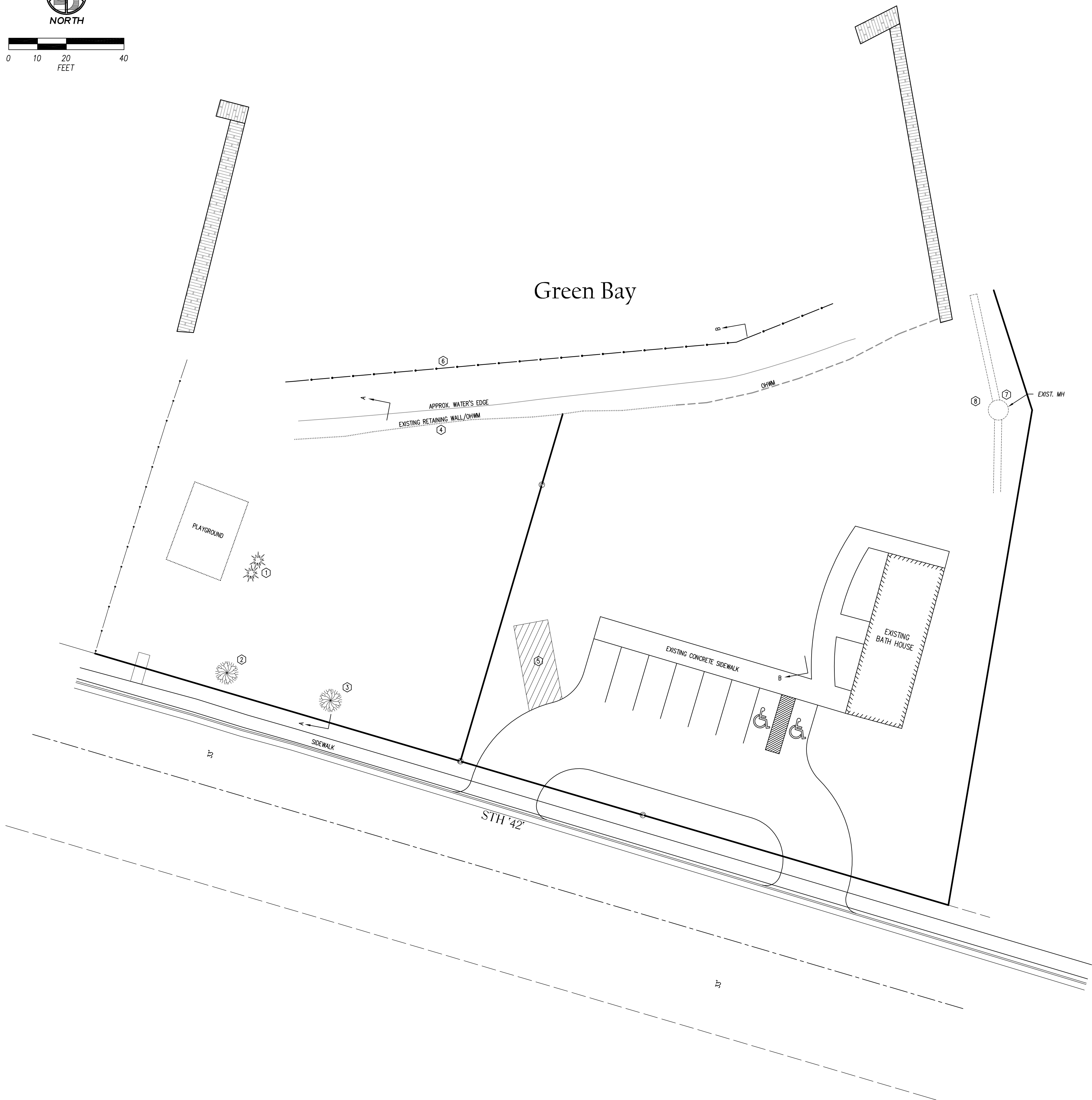
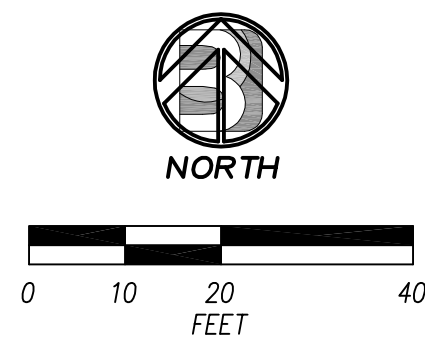

SHEET KEY NOTES

1. REMOVE EXISTING CEDAR TREES AND STUMPS.
2. EXISTING TREE TO BE SAVED. USE TREE SPADE TO REMOVE TREE AND REPLANT IN SIMILAR LOCATION AFTER SITE GRADING IS COMPLETED.
3. EXISTING TREE TO BE SAVED AND KEPT IN PLACE. SURROUND TREE WITH LANDSCAPE RETAINING WALL AND COVER WITH TREE GRATE. FILL BEHIND RETAINING WALL PER PLAN. SEE CROSS SECTION A-A, SHEET C202.
4. REMOVE EXISTING STONE RETAINING WALL, 133 LF. TO BE REPLACED.
5. TEMPORARY STONE TRACKOUT PAD EROSION CONTROL, AS NEEDED. SEE DETAIL A, SHEET C200
6. TURBIDITY BARRIER EROSION CONTROL, 193 LF. SEE DETAIL B, SHEET C200.
7. EXISTING CULVERT DAYLIGHTING INTO BAY TO REMAIN. WIER TO BE PLACED INSIDE EXISTING MANHOLE AT OUTFALL CULVERT WITH TOP OF WIER AT ELEV. 584.60. REMAINING OPENING OF EXISTING CULVERT TO BE USED AS EMERGENCY OVERFLOW. SEE DETAIL XXX, SHEET CXXX.
8. REMOVE 3 CEDAR TREES FOR NEW CULVERT AND CONNECTION TO EXISTING MANHOLE.

REUSE OF DOCUMENTS

DEMOLITION &
EROSION CONTROL
PLAN

Town of Gibraltar - Fish Creek Beach
4108/4112 Main St.
Fish Creek, WI 54212

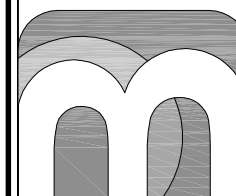

BAUDHUIN
SURVEYING &
ENGINEERING

312 N. 5TH AVE.
P.O. BOX 105
STURGEON BAY, WI.
54235
PHONE: 920-743-8211

REVISION DATE:	DESCRIPTION	DRAWN BY: RMB
		DESIGNED BY: P.J.H.
		DATE: 06-30-20
		JOB NUMBER: 23258

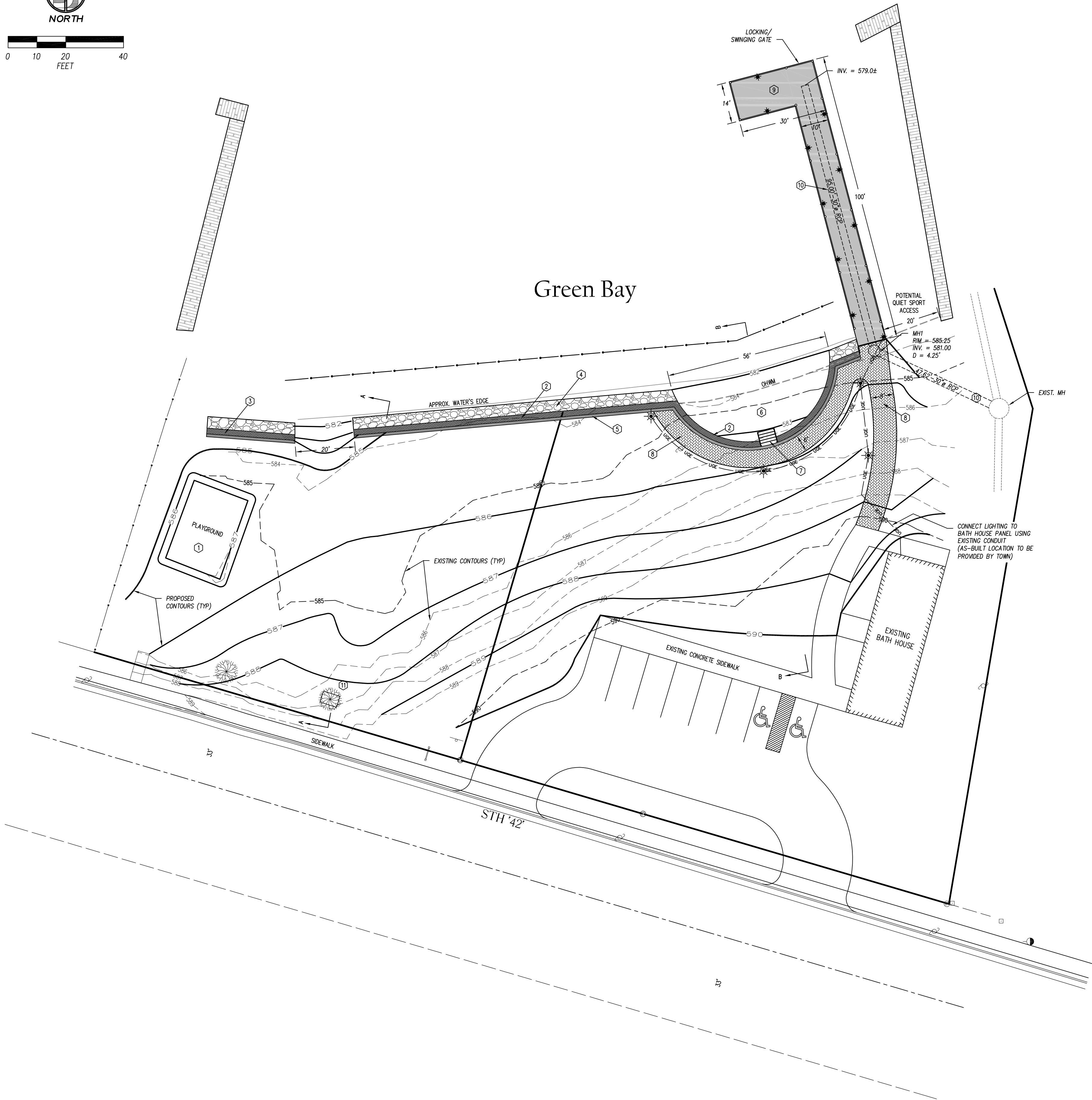
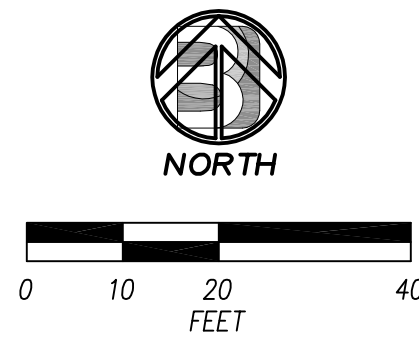

Y:\RMB\LDWG\Gib Beach - 23258.dwg\23258-DES20.dwg



SHEET KEY NOTES

1. PLAYGROUND FINISHED GRADE = 587.00. SURROUND PLAYGROUND WITH TREATED TIMBERS TO 8" ABOVE FINISHED PLAYGROUND GRADE.
2. 24" WIDE NEW RETAINING WALL, 228' LONG WITH 20' WIDE OPENING FOR WALKING ACCESS TO WATER. TOP OF WALL ELEVATION = 585.60. SEE DETAILS A AND B, SHEET C201.
3. RETAINING WALL TOP ELEVATION = 584.60. SEE NOTE 2, THIS SHEET FOR ADDITIONAL NOTES.
4. TEMPORARY RIPRAP PROTECTION PLACED IN FRONT OF ENTIRE LENGTH OF RETAINING WALL EXCEPT FOR WALL AT BEACH. SEE DETAIL A, SHEET C201.
5. 12" WIDE GRASS / PLANTING STRIP IMMEDIATELY BEHIND WALL AND BETWEEN WALL AND WALKWAY. SEE DETAL A, THIS SHEET.
6. BEACH AREA. UNDERCUT AND PLACE 3' MIN. SAND. SEE DETAILS B, SHEET C201 AND SECTION B-B, SHEET C202.
7. STAIRWAY FROM LAWN DOWN TO BEACH. 6" RISE TO 12" RUN, CAST-IN-PLACE CONCRETE. RAILINGS TO BE ADA COMPLIANT. SEE SECTION B-B, SHEET C202.
8. 6' WIDE WALKWAY, TYP., 8' WIDE IN SOME AREAS, AS SHOWN ON PLAN. USE CONCRETE, SEE DETAIL C, SHEET C201. ALTERNATE MATERIAL TO BE BRICK PAVERS, SEE DETAIL D, SHEET C201. APPROX. 1,087 SF.
9. PROPOSED VIEWING DOCK. SEE DETAILS E AND F, SHEET C201
10. RE-DIRECT STORM SEWER UNDER DOCK. SEE PLAN VIEW FOR SIZE AND LENGTH. SEE DETAIL A, SHEET C202.
11. EXISTING TREE TO BE SAVED AND KEPT IN PLACE. SURROUND TREE WITH LANDSCAPE RETAINING WALL AND COVER WITH TREE GRATE. FILL BEHIND RETAINING WALL PER PLAN. SEE CROSS SECTION A-A, SHEET C202.

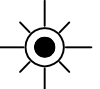
LEGEND

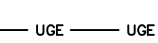
-  BOLLARD LIGHT, 4 EA. SEE SPEC SHEET FOR DETAILS
-  SCALLOP DOCK LIGHT, 11 EA @ 20' O.C. TYP. SEE SPEC SHEET FOR DETAILS
-  ELECTRICAL LINE

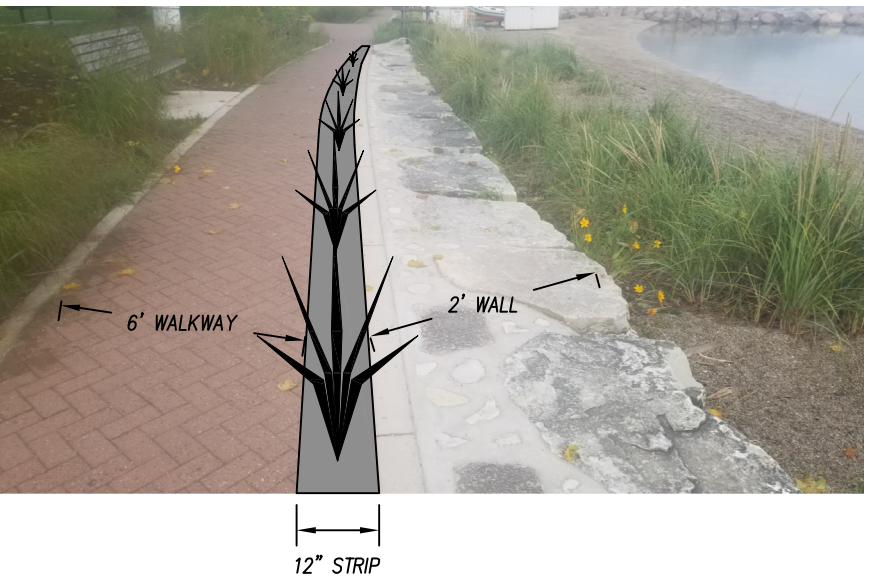

6' WALKWAY
2' WALL
12' STRIP
N.T.S.
GRASS / PLANTING STRIP

REUSE OF DOCUMENTS THIS DOCUMENT HAS BEEN DEVELOPED FOR A SPECIFIC APPLICATION AND NO PART OF IT SHOULD BE REPRODUCED OR USED WITHOUT THE WRITTEN APPROVAL OF BAUDHUIN INCORPORATED. UNAUTHORIZED USE OF THIS DOCUMENT IS THE UNAUTHORIZED USER.	GRADING PLAN	Town of Gibraltar - Fish Creek Beach 4108/4112 Main St. Fish Creek, WI 54212	BAUDHUIN SURVEYING & ENGINEERING	312 N. 5TH AVE. P.O. BOX 105 STURGEON BAY, WI. 54235 PHONE: 920-743-8211	PERSON DATE: DRAWN BY: T.M.E. DESIGNED BY: P.J.H. DATE: 06-30-20 JOB NUMBER: 23258
C101	3				

Y:\RMB\LDWG\Glb Beach - 23258\dwg\23258-DES20.dwg

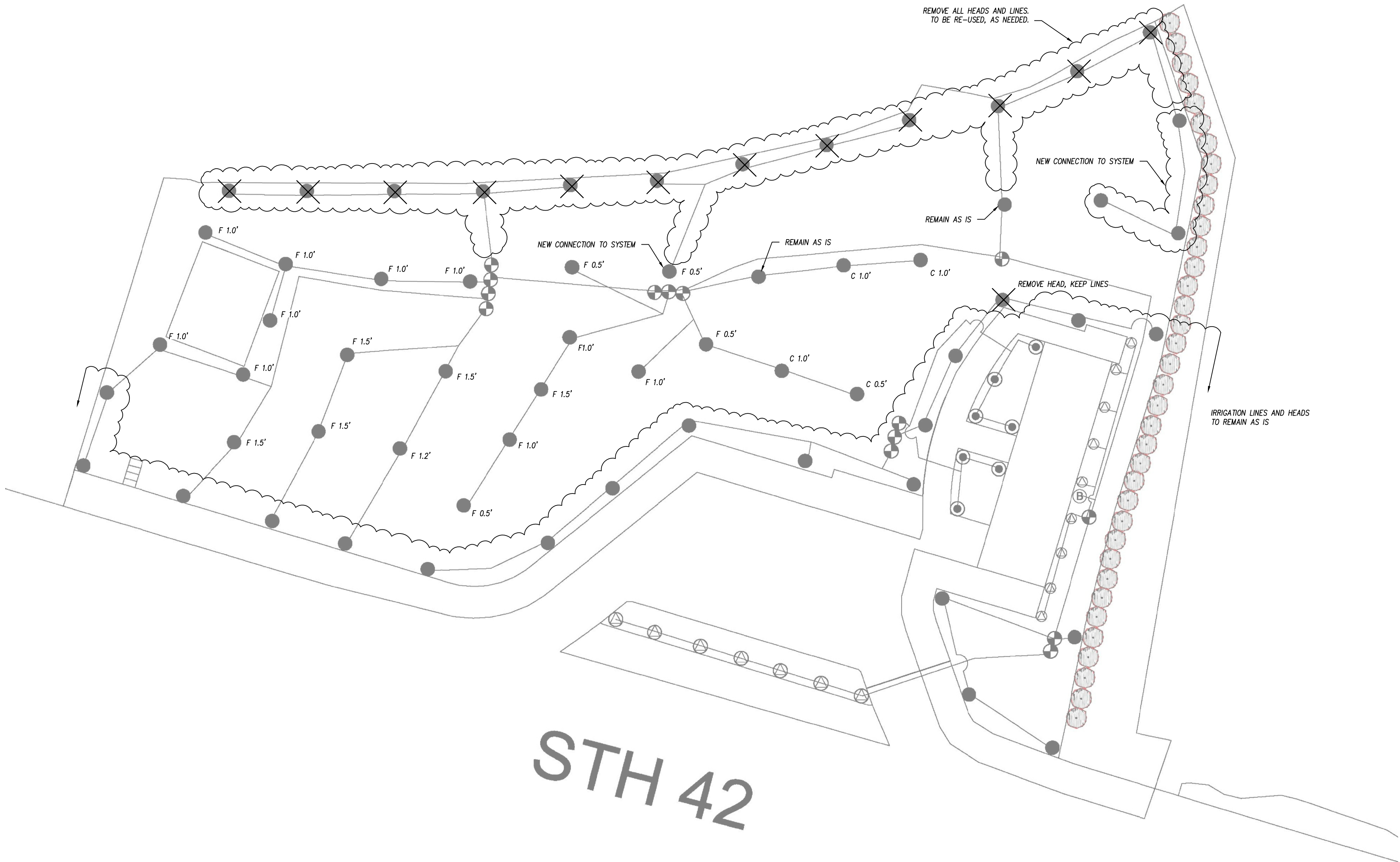
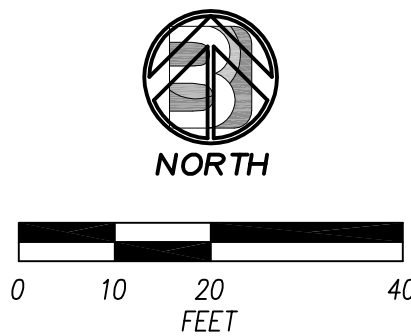

NOTES

1. IRRIGATION LAYOUT, LOCATION, AND LABELS PROVIDED BY CLIENT AND IS NOT GUARANTEED TO BE ACCURATE NOR CORRECT.
2. IRRIGATION HEADS AND LINES TO BE REMOVED OR MODIFIED AS INDICATED ON PLAN VIEW, DUE TO FILLING AND GRADING OPERATIONS.
3. CONTRACTOR HAS OPTION TO RE-USE / EXTEND HEADS OR REPLACE.
4. RAISE CONTROL VALVE / MANIFOLD BOXES, AS NEEDED.

IRRIGATION LEGEND

- RAIN BIRD 5004 ROTOR NOZZLE & ARC VARY
- ⦿ RAIN BIRD 1812 SPRAY HEAD MPR OR VAN NOZZLE & ARC VARY
- ⊙ RAIN BIRD 1804 SPRAY HEAD MPR OR VAN NOZZLE & ARC VARY
- ⦿ CONTROL VALVE
- ▲ 3RC QUCIK COUPLER VALVE
- ⦿ ISOLATION VALVE
- Ⓡ RAIN SENSOR
- Ⓢ CONTROLLER
- Ⓟ AVB - MASTER VALVE
- ⦿ WIRE JUNCTION BOX

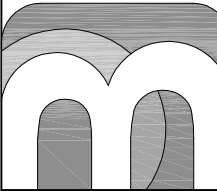

Y:\RMB\LDWG\Gib_Beach - 23258\dwg\23258-DES20.dwg

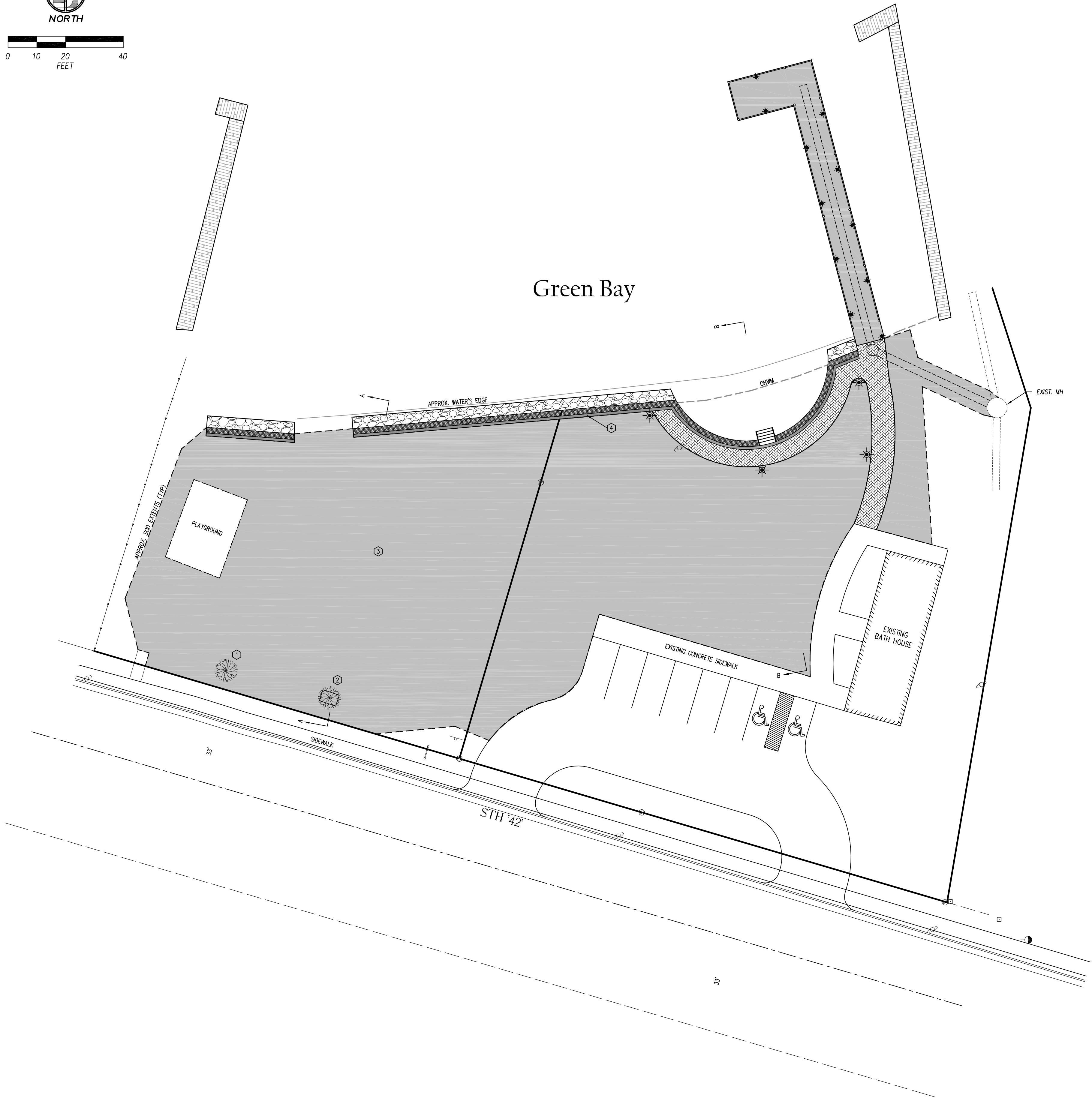
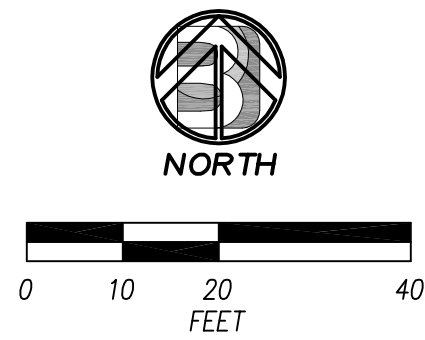

SHEET KEY NOTES

1. EXISTING TREE TO BE SAVED. USE TREE SPADE TO REMOVE TREE AND REPLANT IN SIMILAR LOCATION AFTER SITE GRADING IS COMPLETED.
2. EXISTING TREE TO BE SAVED AND KEPT IN PLACE. SURROUND TREE WITH LANDSCAPE RETAINING WALL AND COVER WITH TREE GRATE. FILL BEHIND RETAINING WALL PER PLAN. SEE CROSS SECTION A-A, SHEET C202.
3. SOD TO BE PREPPED AND PLACED PER SUPPLIER INSTRUCTIONS. APPROX. 22,010 SF.
4. 12" WIDE GRASS / PLANTING STRIP IMMEDIATELY BEHIND WALL AND BETWEEN WALL AND WALKWAY. SEE DETAL A, SHEET C101.

REUSE OF DOCUMENTS
THIS DOCUMENT HAS BEEN DEVELOPED FOR
SPECIFIC APPLICATION AND NO OTHER
GENERAL APPLICATIONS. IT IS NOT TO BE
USED WITHOUT THE WRITTEN APPROVAL OF
BAUDHUIN INCORPORATED. UNAPPROVED USE
IS THE UNAUTHORIZED USER.

C103

LANDSCAPE PLAN

Town of Gibraltar - Fish Creek Beach
4108/4112 Main St.
Fish Creek, WI 54212

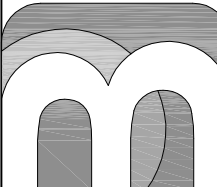

BAUDHUIN
SURVEYING &
ENGINEERING

312 N. 5TH AVE.
P.O. BOX 105
STURGEON BAY, WI.
54235
PHONE: 920-743-8211

REVISION DATE:	DESCRIPTION	DRAWN BY: RWB	DATE: 06-30-20
		DESIGNED BY: P.J.H.	JOB NUMBER: 23258

1. INSTALL EROSION CONTROL MEASURES PER PHASE OF CONSTRUCTION WORK PER PLAN.
2. REMOVE IRRIGATION HEADS AND PIPING AS NEEDED FOR MASS GRADING AND RE-USE.
3. INSTALL STORM SEWER & UTILITIES PER PLAN.
4. CONSTRUCT RETAINING WALL, BEACH, AND RIPRAP PROTECTION.
5. PLACE BASE COURSE AND CONSTRUCT PAVED WALKWAY.
6. CONSTRUCT DOCK.
7. LANDSCAPE AND STABILIZE DISTURBED SOIL WITH SOD PER PLAN.
8. RE-CONNECT AND EXTEND IRRIGATION AS NEEDED PER PLAN.
9. REMOVE EROSION CONTROL MEASURES WHEN GRASS HAS BEEN WELL ESTABLISHED.

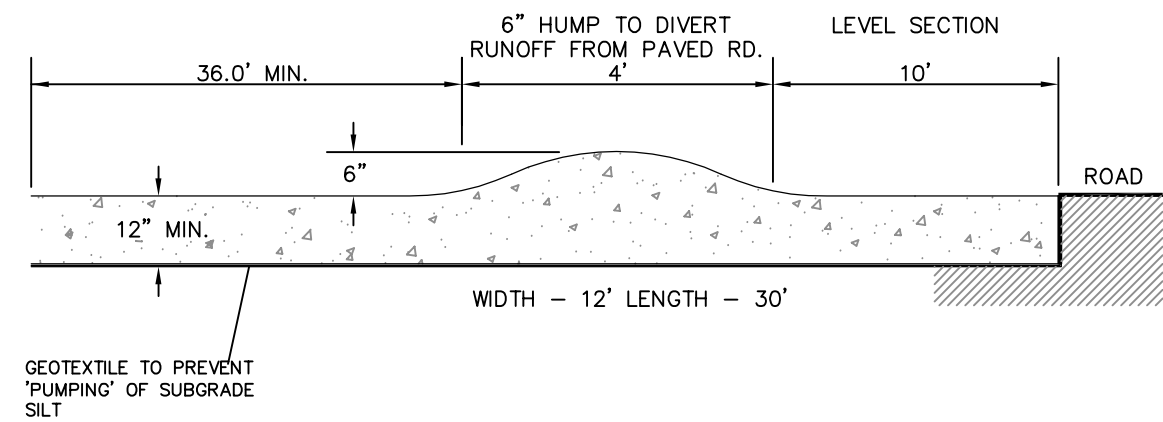

SPECIFICATIONS:

- CLEAR THE ENTRANCE / EXIT AREA OF ALL VEGETATION, ROOTS, AND OTHER OBJECTIONABLE MATERIAL.
- GRADE THE ROAD FOUNDATION SO THAT THE ENTRANCE/EXIT WILL HAVE A CROSS SLOPE.
- PLACE STONE TO THE DIMENSIONS, GRADE AND ELEVATION SHOWN.
- USE WASHED STONE 3" TO 6" IN SIZE. DO NOT COMPACT AGGREGATE.
- MAINTAIN THE STONE PAD IN A CONDITION TO PREVENT MUD OR SEDIMENT FROM LEAVING THE SITE.
- MUD OR SEDIMENT THAT IS TRACKED OR WASHED ONTO ROAD MUST BE REMOVED IMMEDIATELY.
- TRACKOUT PAD SHALL CONFORM TO WDNR TECHNICAL STANDARD 1057.

1. IN ACCORDANCE WITH NR 216.46(9) AND NR 216.48(4), THE LANDOWNER, OR THE LANDOWNER'S REPRESENTATIVE, SHALL INSPECT EROSION AND SEDIMENT CONTROL PRACTICES WEEKLY, AND WITHIN 24 HOURS FOLLOWING A RAINFALL OF 0.5 INCHES OR GREATER. WRITTEN DOCUMENTATION OF EACH INSPECTION SHALL BE MAINTAINED AT THE CONSTRUCTION SITE AND SHALL INCLUDE THE TIME, DATE, LOCATION OF INSPECTION, PHASE OF LAND DISTURBANCE AT THE CONSTRUCTION SITE, PERSON CONDUCTING THE INSPECTION, ASSESSMENT OF CONTROL PRACTICES, AND A DESCRIPTION OF ANY EROSION OR SEDIMENT CONTROL MEASURE INSTALLATION OR MAINTENANCE PERFORMED IN RESPONSE TO THE INSPECTION.
2. ANY SOIL STOCKPILE THAT REMAINS FOR MORE THAN 7 DAYS SHALL BE COVERED OR TREATED WITH STABILIZATION PRACTICES SUCH AS TEMPORARY OR PERMANENT SEEDING AND MULCHING. SEEDING SHALL FOLLOW THE REQUIREMENTS OF WDNR TECHNICAL STANDARDS 1058 AND 1059 AND WIS. DOT STANDARD SPECIFICATIONS, SECTION 630.
3. A MINIMUM OF 4 TO 6 INCHES OF TOPSOIL MUST BE APPLIED TO ALL AREAS TO BE SEED OR SODDED ACCORDING TO WDNR TECHNICAL STANDARD 1059.
4. ALL OFF-SITE SEDIMENT DEPOSITS OCCURRING AS A RESULT OF CONSTRUCTION WORK OR STORM EVENT SHALL BE CLEANED UP BY THE END OF EACH DAY. FLUSHING SHALL NOT BE ALLOWED. IMPLEMENT TEMPORARY GRADING PRACTICES AS DESCRIBED IN WDNR TECHNICAL STANDARDS 1066 AND 1067 TO PREVENT SEDIMENT FROM LEAVING THE SITE.
5. ALL DISTURBED AREAS SHALL BE TREATED WITH STABILIZATION MEASURES, AS SPECIFIED, WITHIN 3 WORKING DAYS OF FINAL GRADING.
6. ANY SOIL EROSION THAT OCCURS AFTER FINAL GRADING AND/OR APPLICATION OF STABILIZATION MEASURES MUST BE REPAIRED AND STABILIZATION WORK REDONE.
7. TREAT ANY DISTURBED AREA THAT REMAINS INACTIVE FOR GREATER THAN 30 WORKING DAYS OR WHERE GRADING WORK EXTENDS BEYOND THE PERMANENT SEEDING DEADLINES WITH TEMPORARY BEST MANAGEMENT PRACTICES (BMPs) SUCH AS LAND APPLICATION OF ANIONIC POLYACRYLAMIDE, STRAW BALES, SILT FENCE, MULCHING, TEMPORARY SEEDING, AND SEDIMENT TRAPS AS RESPECTIVELY REQUIRED BY WDNR TECHNICAL STANDARDS 1050, 1055, 1056, 1058, 1059, AND 1063.
8. ALL TEMPORARY BMPs SHALL BE MAINTAINED UNTIL THE SITE IS STABILIZED.
9. WIND EROSION SHALL BE KEPT TO A MINIMUM DURING CONSTRUCTION. WATERING, MULCHING, OR A TACKING AGENT MAY NEED TO BE UTILIZED TO PROTECT NEARBY RESIDENTS AND WATER RESOURCES. DUST CONTROL MEASURES SHALL BE IMPLEMENTED ACCORDING TO WDNR TECHNICAL STANDARD 1068.
10. WHEN THE DISTURBED AREA HAS BEEN STABILIZED BY PERMANENT VEGETATION OR OTHER MEANS, TEMPORARY BMPs SUCH AS SILT FENCE, STRAW BALES, AND SEDIMENTS TRAPS SHALL BE REMOVED.
11. ALL REMAINING TOPSOIL STOCKPILES SHALL BE SEED OR HAULED OFF-SITE WITHIN 60 DAYS OF CONSTRUCTION COMPLETION.
12. **WINTER STABILIZATION:** ALL AREAS REQUIRING SEED AFTER OCTOBER 15TH SHALL BE STABILIZED BY AN APPROVED WINTER STABILIZATION METHOD. THE RECOMMENDED METHOD IS UTILIZING A HYDROSEEDER CONTAINING ADEQUATE TACKIFIER POLYMER MIXED WITH WINTER WHEAT OR RYE SEED. ANOTHER ACCEPTABLE EROSION CONTROL METHOD IS THE LAND APPLICATION OF ANIONIC POLYACRYLAMIDE IN CONFORMANCE WITH WDNR TECHNICAL STANDARD 1050.
13. ADDITIONAL EROSION CONTROL METHODS SUCH AS SILT FENCE, BALE CHECKS, EROSION MAT, (ABOVE AND BEYOND THE QUANTITIES LISTED IN THE BID PROPOSAL) AS NEEDED TO PREVENT WASHOUT OR SILT TRANSFER PROBLEMS WITHIN THE CONSTRUCTING AREA OR DOWNSTREAM SHALL BE CONSIDERED INCIDENTAL TO THIS PROPOSAL.

(REFER TO EROSION CONTROL PLAN FOR APPLICABLE AREAS)

STANDARD BIODEGRADABLE MAT: CLASS 1, TYPE A, AS LISTED IN THE LATEST EDITION OF THE WIS. DOT EROSION CONTROL P.A.L. PRODUCTS WITH UV DEGRADABLE NETTING SHALL NOT BE INSTALLED AFTER SEPTEMBER 1ST. TYPE B MAT MAY BE USED IN REPLACEMENT FOR TYPE A MAT AT THE OPTION OF THE CONTRACTOR WITH NO ADDITIONAL COST TO THE OWNER. EROSION MAT SHALL ALSO MEET THE REQUIREMENTS OF WDNR TECHNICAL STANDARD 1053.

STAPLES: USE U-SHAPED STAPLES NO. 11 GAUGE OR HEAVIER STEEL WIRE OR OTHER APPROVED MATERIALS, WITH A WIDTH OF ONE TO TWO INCHES, AND A LENGTH NOT LESS THAN 6 INCHES FOR FIRM SOILS AND NOT LESS THAN 12 INCHES FOR LOOSE SOILS.

RIPRAP, LIGHT: 4-13" ROCK, 0% > 16", 2% OR LESS < 1", OVER 8 OZ. GEOTEXTILE FILTER FABRIC
DECORATIVE STONE MAY BE USED AS LONG AS IT MEETS SPECIFICATIONS.

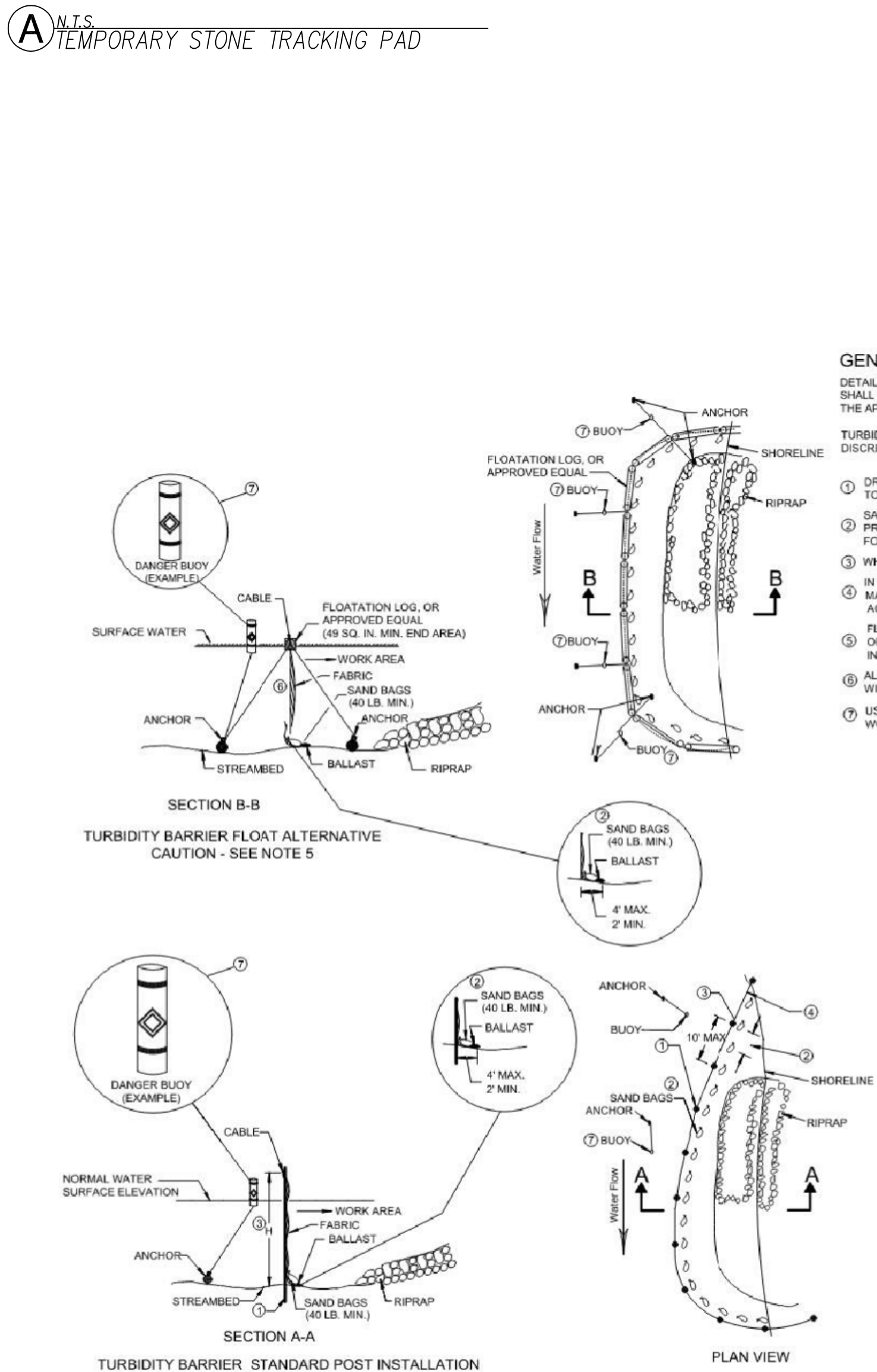

DETAILS OF CONSTRUCTION, MATERIALS AND WORKMANSHIP NOT SHOWN ON THIS DRAWING SHALL CONFORM TO THE PERTINENT REQUIREMENTS OF THE STANDARD AND THE APPLICABLE SPECIAL PROVISIONS

TURBIDITY BARRIER MAY BE REMOVED AT THE ENGINEERS OR PROJECT MANAGERS DISCRETION, WHEN PERMANENT EROSION CONTROL MEASURES HAVE BEEN ESTAB

- ① DRIVEN STEEL POSTS, PILES, OR CHANNELS. LENGTH SHALL BE SUFFICIENT TO SECURELY SUPPORT BARRIER AT HIGH WATER ELEVATIONS.
- ② SANDBAGS TO BE USED AS ADDITIONAL BALLAST WHEN ORDERED BY THE ENGINEER OR PROJECT MANAGER TO MEET ADVERSE FIELD CONDITIONS. SPACE AS APPROPRIATE FOR FORTS COORDINATION.
- ③ WHEN BARRIER HEIGHT, H, EXCEEDS 8 FT., POST SPACING MAY NEED TO BE DECREASED.
- ④ IN WATERWAYS SUBJECT TO FLUCTUATING WATER ELEVATIONS, PROVISIONS SHOULD BE MADE TO ALLOW THE WATER TO EQUALIZE ON EACH SIDE OF THE BARRIER. THIS MAY BE ACCOMPLISHED BY LEAVING A PORTION OF THE BARRIER OPEN ON THE UPSTREAM END.
- ⑤ FLOAT ALTERNATIVE WILL ONLY BE ALLOWED WITH WRITTEN APPROVAL OF THE ENGINEER OR PROJECT MANAGER, AND IS MEANT FOR LOCATIONS WHERE BED ROCK PREVENTS THE RIVER FROM FLOODING.
- ⑥ ALLOW SUFFICIENT BULK VERTICALLY AND HORIZONTALLY SO THAT SEDIMENT BUILD UP WILL NOT SEPARATE OR LOWER THE TURBIDITY BARRIER.
- ⑦ USE AS DIRECTED BY COAST GUARD OR DNR PERMIT WHEN WORKING IN NAVIGABLE WATERWAYS.

This drawing based on Wisconsin
Department of Transportation
Standard Detail Drawing 8 E 11-2

B N.I.S.
TURBIDITY BARRIER

CONTRACTOR IS RESPONSIBLE FOR MAINTENANCE AND DOCUMENTATION OF EROSION CONTROL MEASURES THROUGHOUT CONSTRUCTION PHASE. OWNER IS RESPONSIBLE FOR MAINTENANCE AFTER CONTRACTOR LEAVES THE SITE.

Y:\RMB\LDWG\Cib Beach - 23258.dwg 23258-DES20.dwg

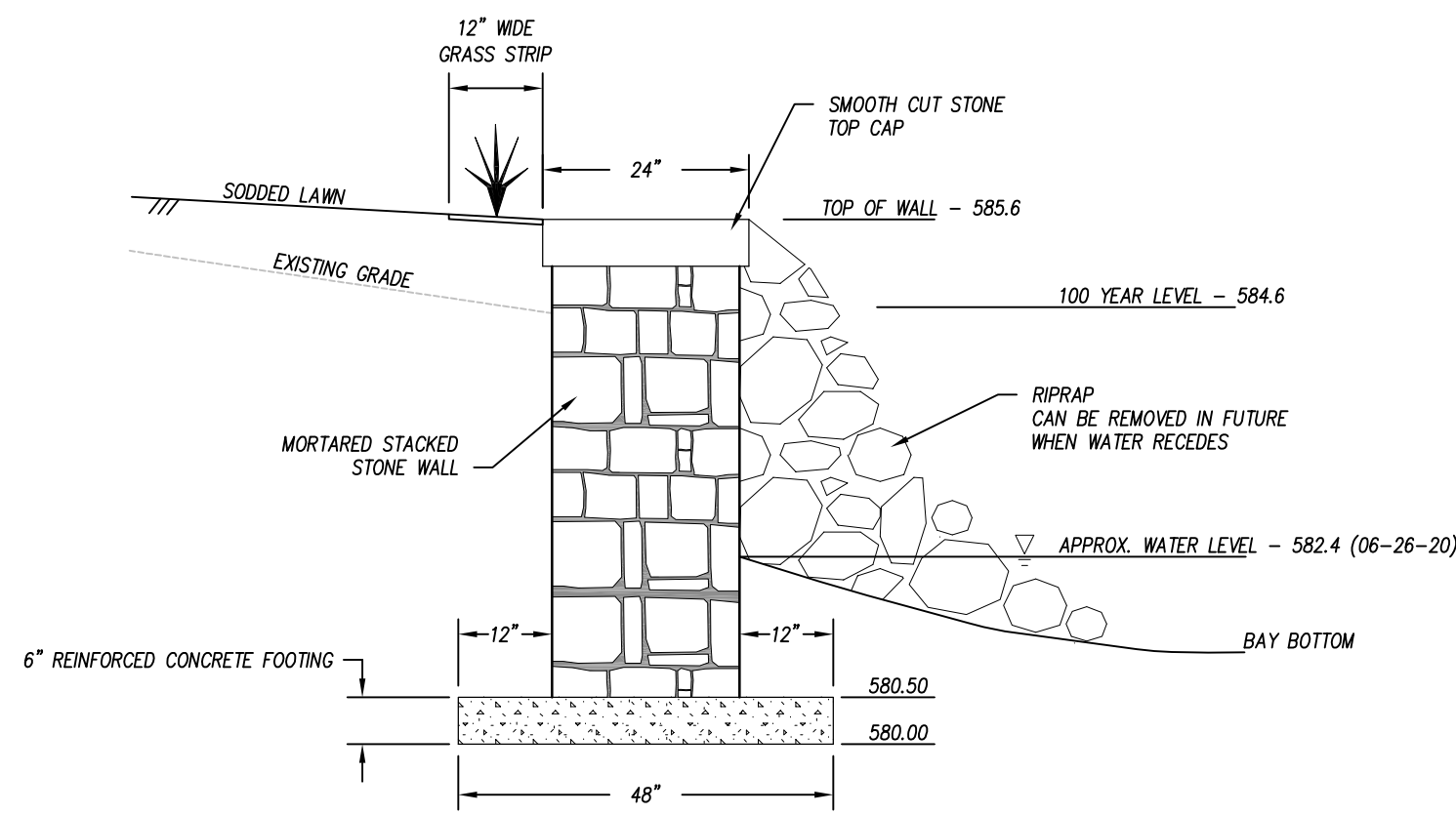

A N.T.S.
NEW WALL CROSS-SECTION, AT LAWN

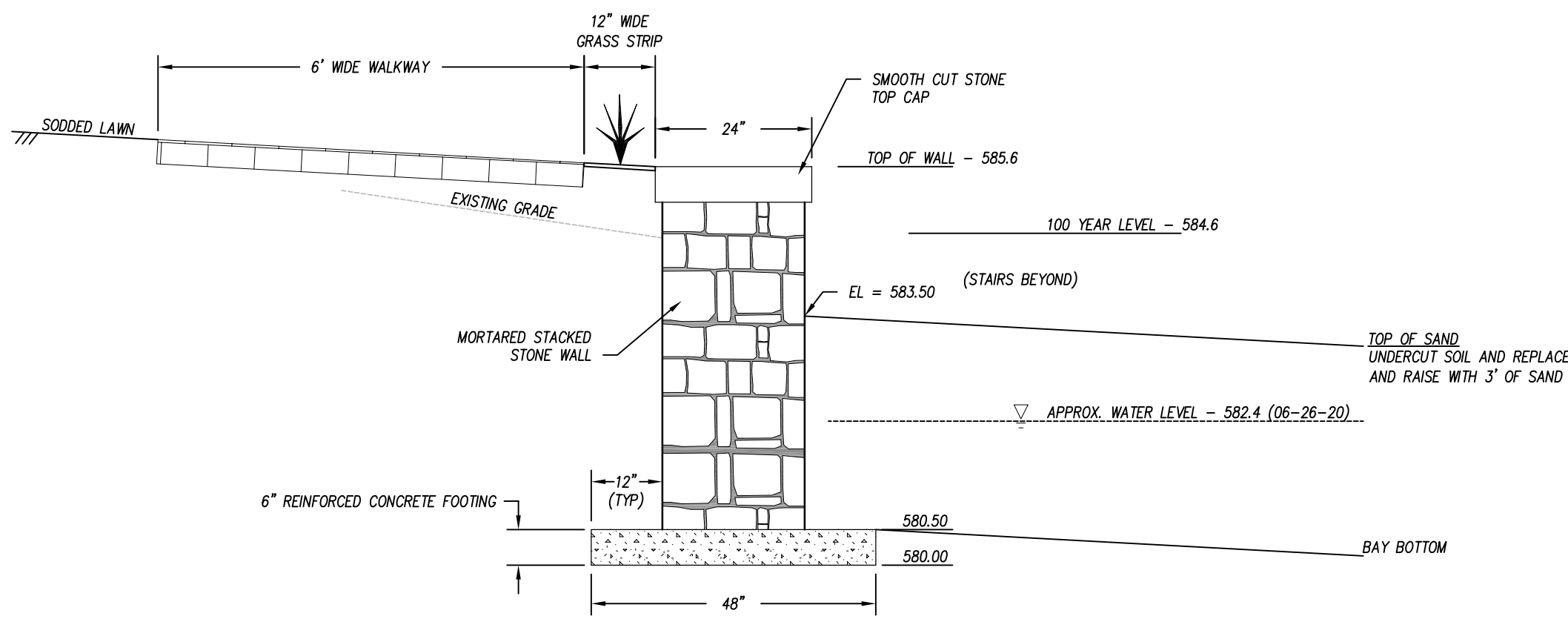

B N.T.S.
NEW WALL CROSS-SECTION, AT BEACH

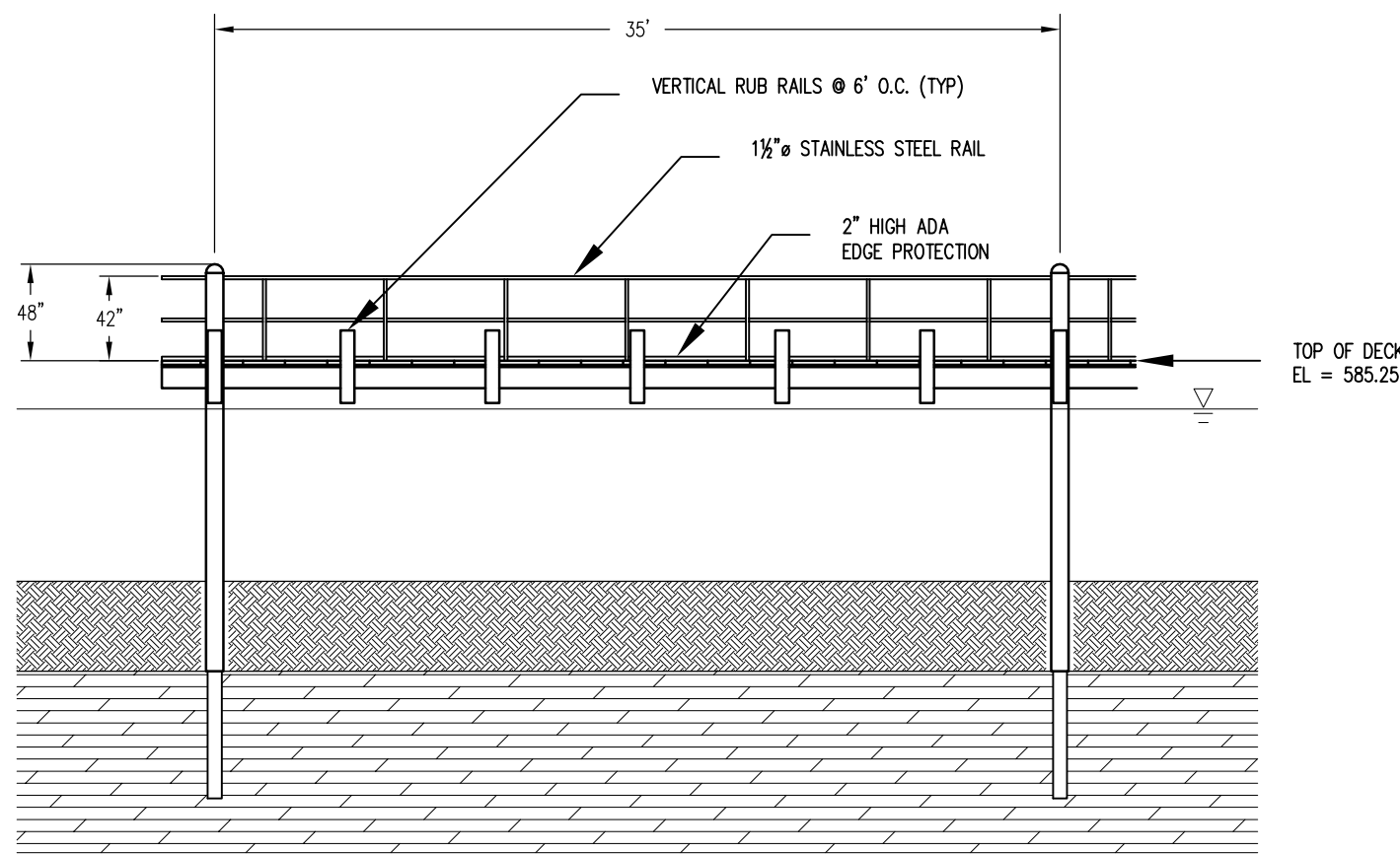

E N.T.S.
PROPOSED DOCK TYPICAL TRANSVERSE SECTION

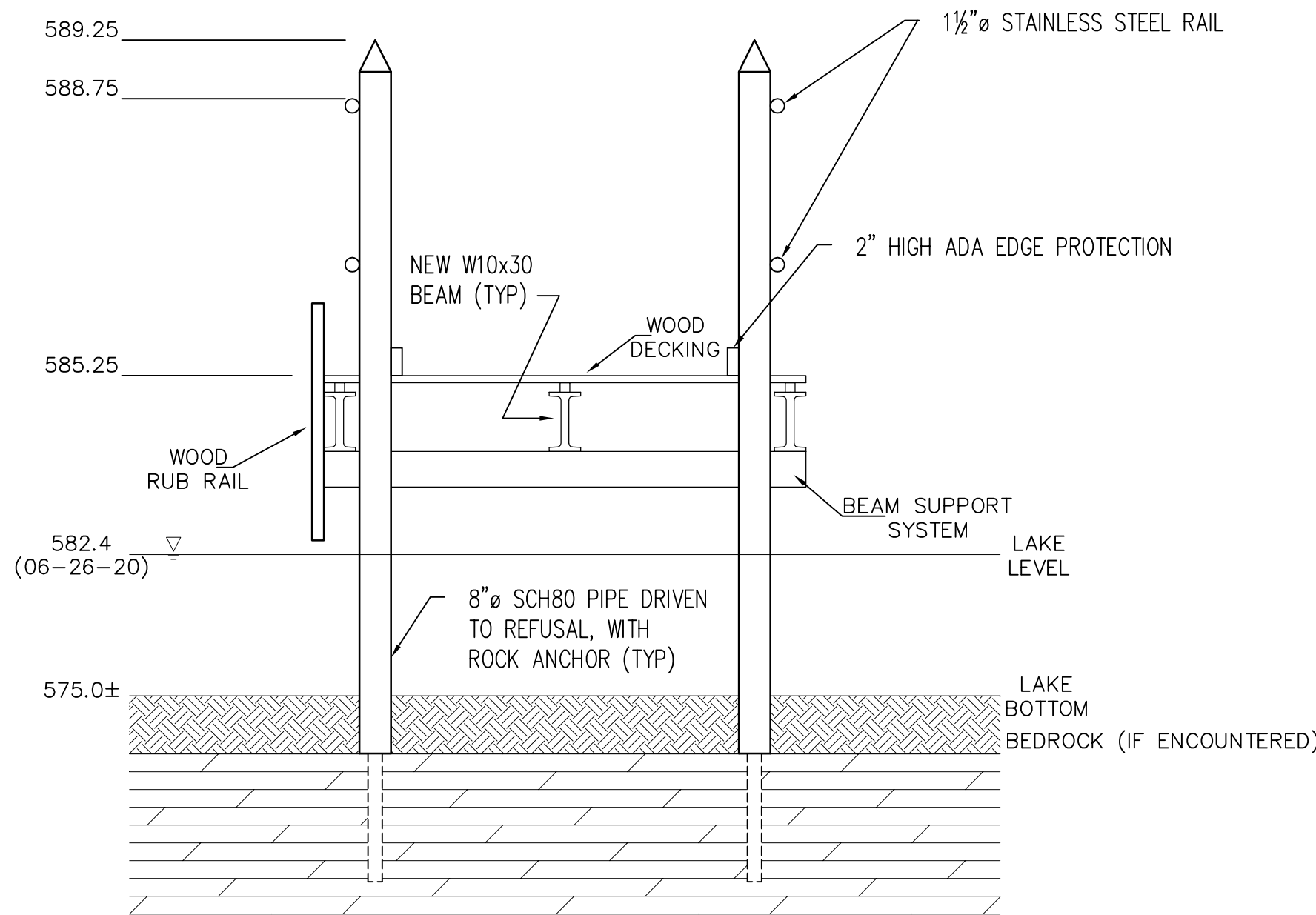

F N.T.S.
PROPOSED DOCK TYPICAL CROSS-SECTION

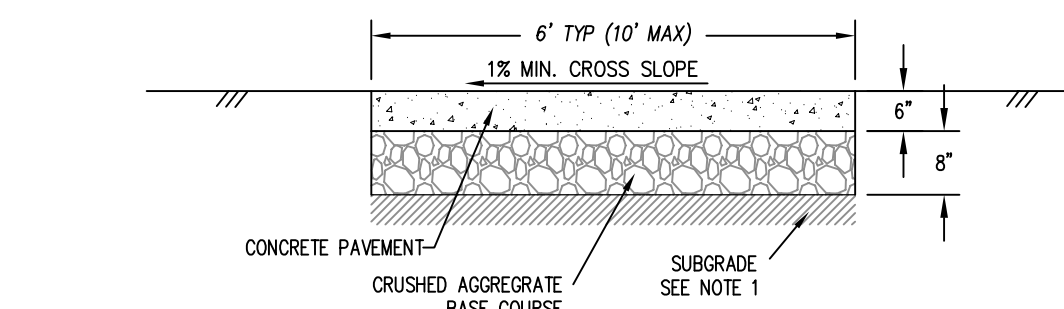

- NOTES
1. COMPACT SUBGRADE TO 95% STANDARD PROCTOR. SUBGRADE TO BE INSPECTED BY PROJECT FOREMAN PRIOR TO PLACEMENT OF AGGREGATE BASE COURSE.
- SPECIFICATIONS
- BASE COURSE SHALL BE 3/4" MINUS CRUSHED AGGREGATE.
 - CONCRETE PAVEMENT CONSTRUCTION SHALL BE IN ACCORDANCE WITH WISCONSIN DOT FDM.
 - CONCRETE SHALL BE 4,000 PSI MINIMUM.
 - CONCRETE SHALL RECEIVE A BROOMED FINISH.

C N.T.S.
CONCRETE WALKWAY - 6" THICKNESS

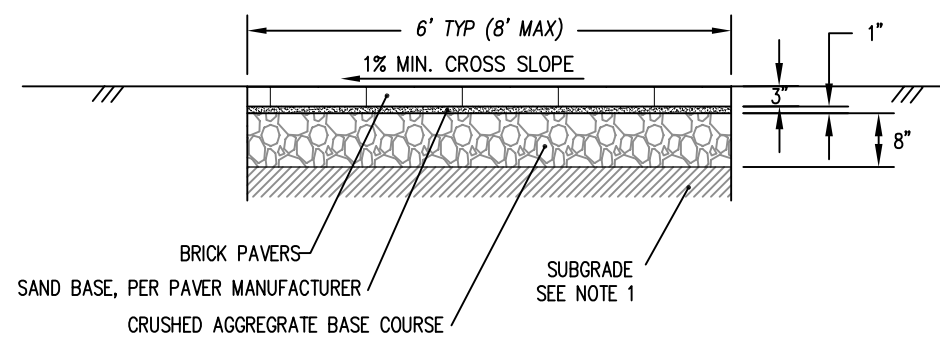

- NOTES
1. COMPACT SUBGRADE TO 95% STANDARD PROCTOR. SUBGRADE TO BE INSPECTED BY PROJECT FOREMAN PRIOR TO PLACEMENT OF AGGREGATE BASE COURSE.
- SPECIFICATIONS
- BASE COURSE SHALL BE 3/4" MINUS CRUSHED AGGREGATE.

D N.T.S.
ALTERNATE: BRICK PAVERS WALKWAY



G N.T.S.
PROPOSED RAILING, SIMILAR TO PICTURED

REUSE OF DOCUMENTS THIS DOCUMENT HAS BEEN DEVELOPED FOR A SPECIFIC APPLICATION AND NOT FOR GENERAL USE. THEREFORE IT MAY NOT BE REUSED IN OTHER PROJECTS WITHOUT THE WRITTEN PERMISSION OF BAUDHUIN INCORPORATED. UNAUTHORIZED REUSE IS THE SOLE RESPONSIBILITY OF THE USER.	CONSTRUCTION DETAILS	Town of Gibraltar - Fish Creek Beach 4108/4112 Main St. Fish Creek, WI 54212	BAUDHUIN SURVEYING & ENGINEERING	312 N. 5TH AVE. P.O. BOX 105 STURGEON BAY, WI. 54235 PHONE: 920-743-8211	REVISION DATE: DRAWN BY: DESIGNED BY: DATE: JOB NUMBER: 23258
C201	7				

Y:\RMB\LDWG\Gib Beach - 23258\dwg\23258-DES20.dwg

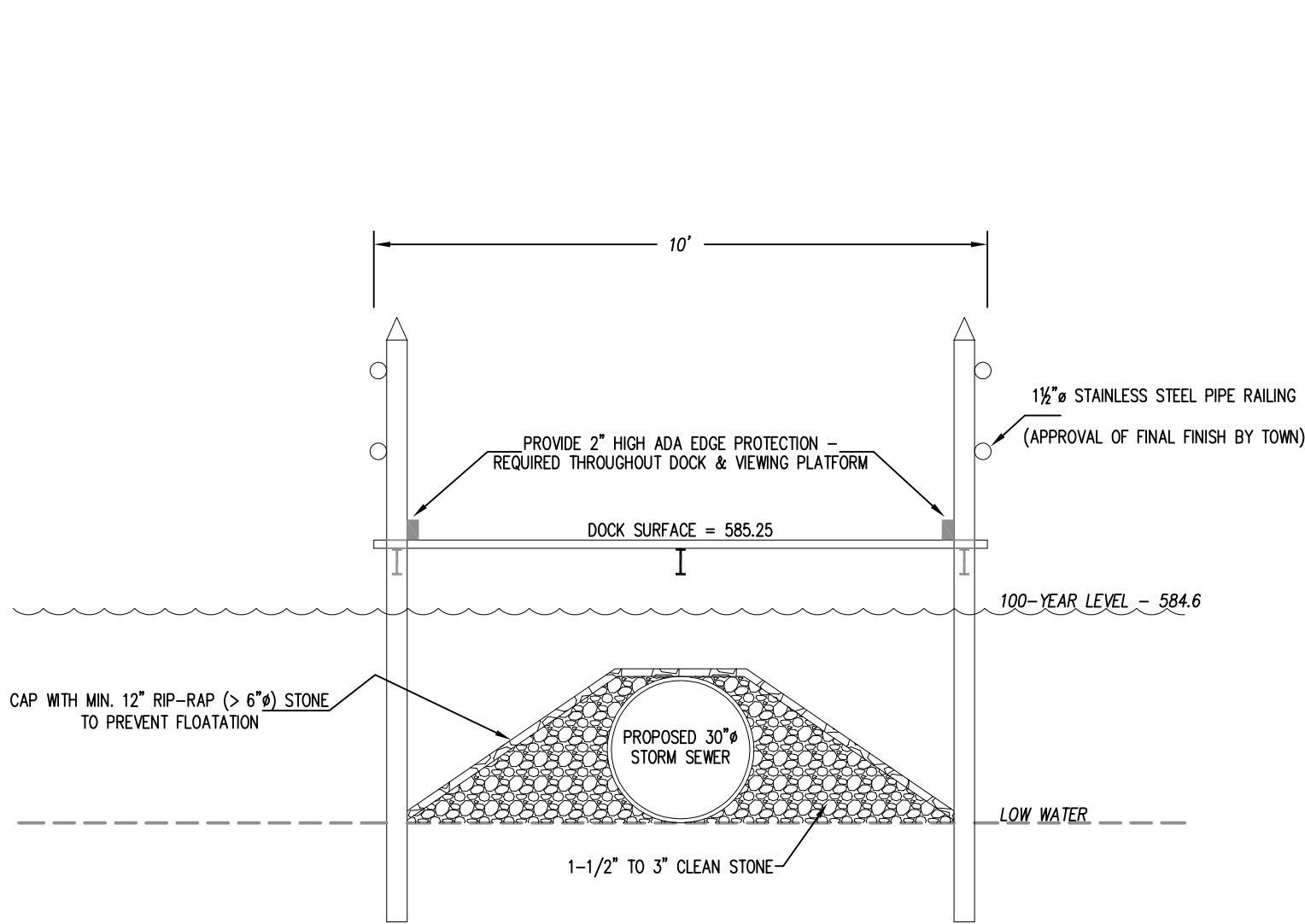

A N.T.S. PROPOSED STORM SEWER OUTLET, CROSS-SECTION

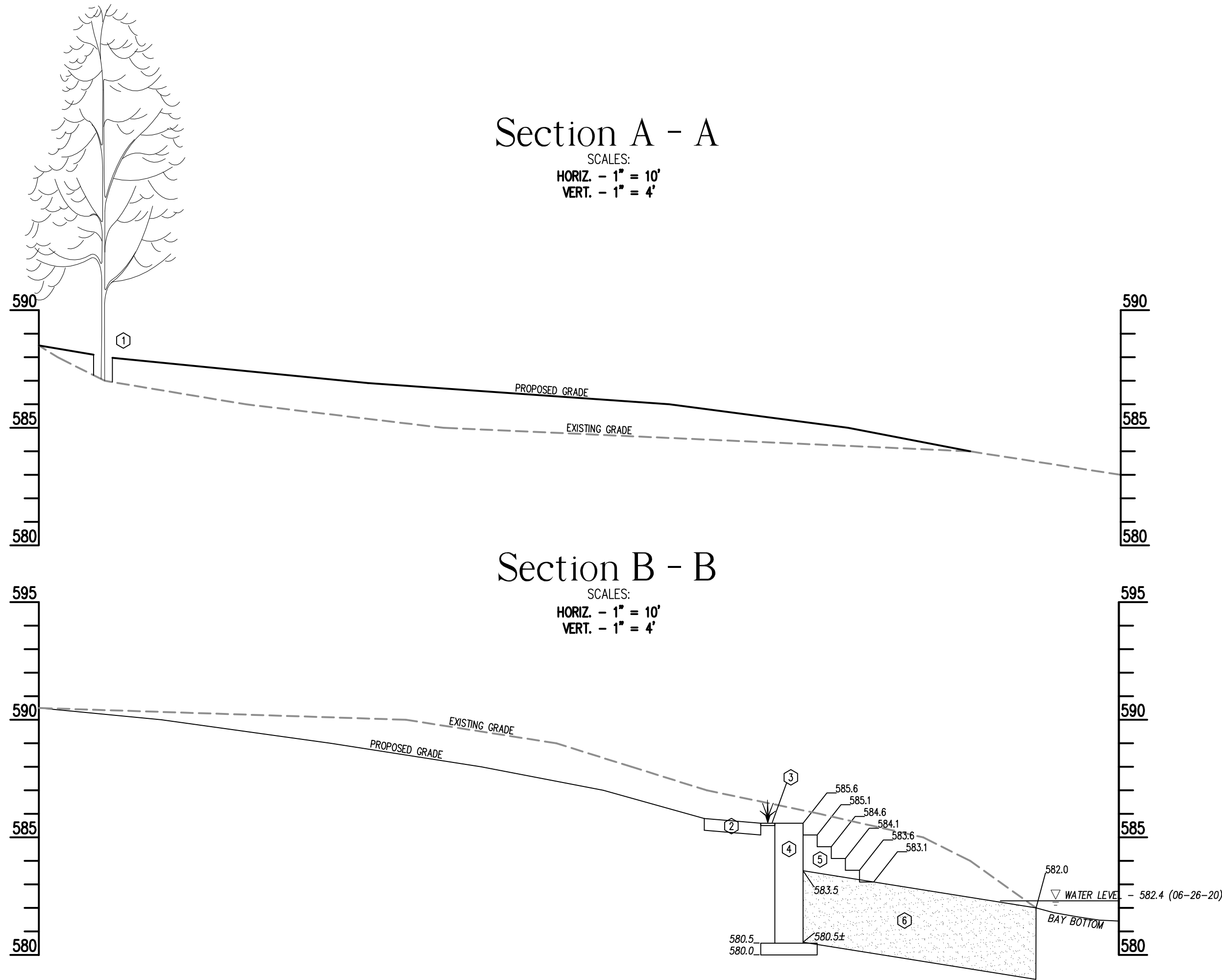

Section A - A

SCALES:
HORIZ. - 1" = 10'
VERT. - 1" = 4'

Section B - B

SCALES:
HORIZ. - 1" = 10'
VERT. - 1" = 4'

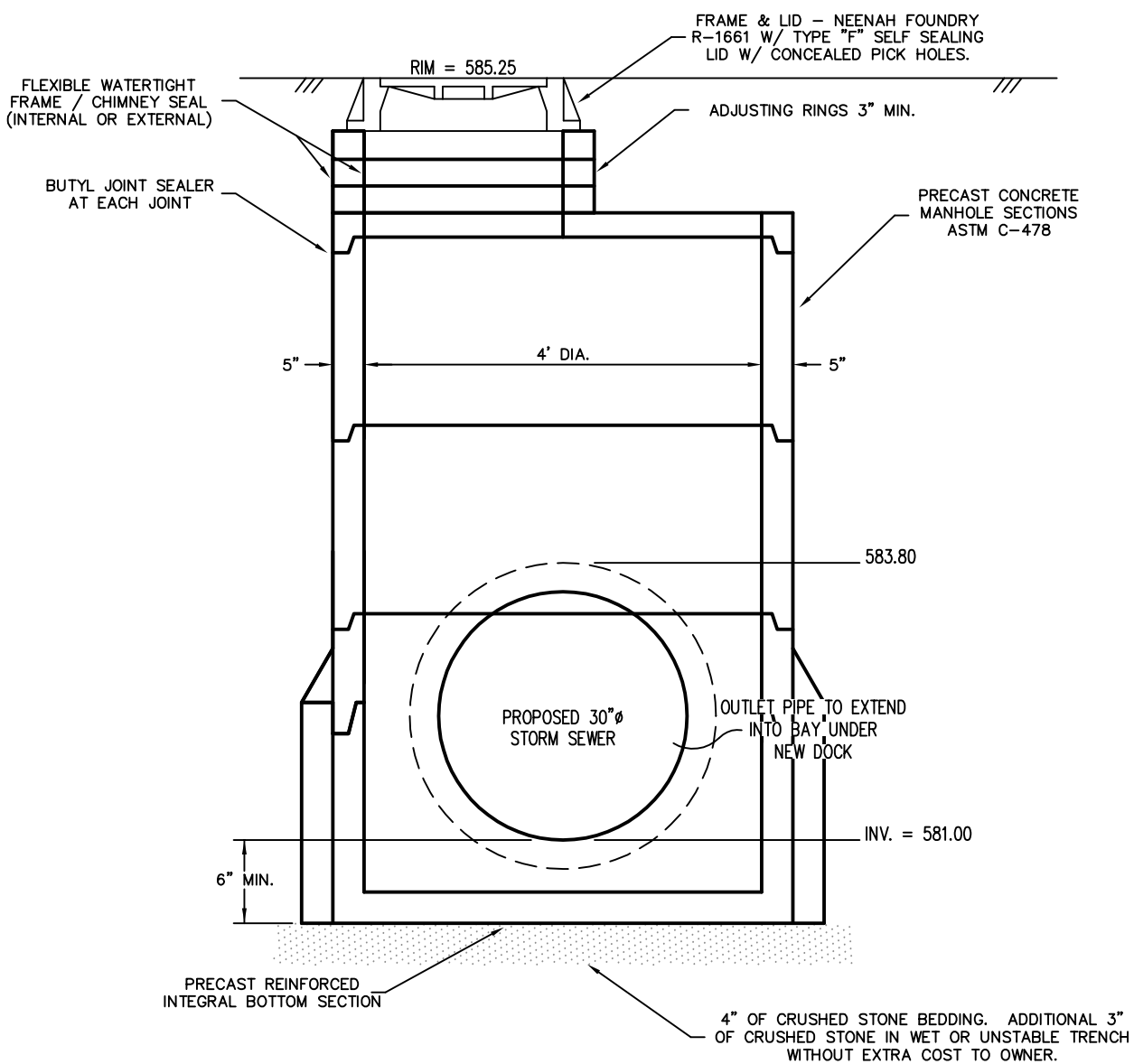

B N.T.S. PROPOSED STORM SEWER MANHOLE 1

SHEET KEY NOTES

- EXISTING TREE TO BE SAVED AND KEPT IN PLACE. USE LANDSCAPE STACKABLE STONE RETAINING WALL (FINAL PRODUCT TO BE SELECTED BY OWNER) SURROUNDING TREE AND TOPPED WITH 48"x72" TREE GRATE WITH 30" OPENING, NEENAH R-8819 OR APPROVED EQUAL. SEE SPEC. SHEETS FOR GRATE DETAILS. FILL AND GRADE SURROUNDING AND BEHIND WALL PER PLAN. STONE WALL HEIGHT TO BE 18" MAX.
- 6' WIDE WALKWAY (TYPICAL), SEE DETAILS C AND D, SHEET C201.
- 12" WIDE GRASS / PLANTING STRIP, SEE DETAIL A, SHEET C101.
- NEW RETAINING WALL. SEE DETAILS A & B, SHEET C201.
- STAIRS, 6" RISE : 12" RUN, CAST-IN-PLACE CONCRETE. RAILINGS (NOT SHOWN) TO BE ADA COMPLIANT.
- SAND PLACEMENT. UNDERCUT GROUND AND PLACE 3' MINIMUM SAND. GRADATIONS PER SPEC SHEETS.

REUSE OF DOCUMENTS
THIS DOCUMENT HAS BEEN DEVELOPED FOR
SPECIFIC APPLICATION AND NOT BE
GENERALIZED. ANY REUSE OF THIS
DOCUMENT WITHOUT THE WRITTEN APPROVAL OF
BAUDHUIN INCORPORATED, UNAPPROVED USE
IS THE UNAUTHORIZED USER.

C202 8

CONSTRUCTION DETAILS

Town of Gibraltar - Fish Creek Beach
4108/4112 Main St.
Fish Creek, WI 54212

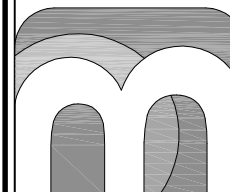

BAUDHUIN
SURVEYING &
ENGINEERING

312 N. 5TH AVE.
P.O. BOX 105
STURGEON BAY, WI.
54235
PHONE: 920-743-8211

PERSON DATE:	DESCRIPTION:	DATE:
DRAWN BY: T.M.E.		
DESIGNED BY: P.J.H.		
DATE: 06-30-20		
JOB NUMBER: 23258		